



# Smart Tracker

Twins

## Quick Start Guide

### Special Reminder:

1. The Bluetooth signal will be affected by water and metal. When using T1, please try to avoid metal and other obstacles between two trackers to reduce the possibility of Bluetooth disconnection.
2. T1's signal is very sensitive. Therefore, in safe areas such as home and office, please turn off trackers to avoid false alarm.
3. The volume of tracker is about 80-90 decibels. It may not be heard in very noisy environments. It is suggested that in normal use, put tracker in the place where the sound is not blocked, such as hanging on mobile phones, keys, bags, or in jacket pockets, etc.

## Instructions:

### 1 Turn on

Please press tracker's button for 5 seconds, tracker beeps and turns on.

### 2 Turn off

When tracker is on, please press its button again for 5 seconds, the equipment beeps and will shut down.

### 3 Pair with each other

When both trackers are off, please simultaneously press both trackers' buttons for 10 seconds (After pressing for 5 seconds, tracker will enter the boot state, the device will beep at this time. Please do not loosen and continue to press the button until 10 seconds have elapsed) until its red light flashes quickly and continuously, indicating it is ready for pairing. When the light no longer flashes, the pairing is completed. Now, double-click the button of one tracker, the other one beeps, indicating that they have paired with each other, and they can be used normally.

**Notice:** If you have more than one pair of twins, trackers of the same color couldn't pair with each other. And one white tracker could only pair with one black piece. If you need to re-pair, please turn off the trackers and follow the above instructions.

### 4 How to view tracker's state

Please click tracker's button one time, then:

- 4.1. The red light flashes once: tracker connects to the other one normally.
- 4.2. Tracker beeps: tracker is in Bluetooth broadcast state, and does not pair with the other one.
- 4.3. No response: tracker is off.

### 5 Tether the tracker to items

You can tether tracker to keyrings, wallets, satchels, schoolbags and other items with strap, or put it in your pocket. To install the strap, please refer to the picture.

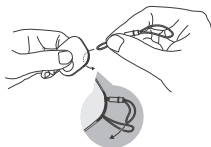
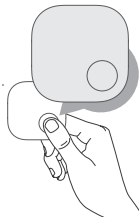

## Main Function:

### 1 Disconnection alarm

After two trackers connect to each other, Twins will beep for about 5 seconds with 80-90 decibels when they are 10-20 meters away from each other, which means they are disconnected from each other. The alarm will prevent you from forgetting or losing the other one.

### 2 Find each other

Tether Twins to some items (such as keys), and when two trackers are connected to each other (the distance is about 10-20 meters), double-click one tracker's button, the other tracker will beep for about 5 seconds with 80-90 decibels. The sound will help you find the items quickly.

### 3 Reconnect automatically

If the paired Twins disconnected, when they are in the bluetooth range again (about 10-20 meters), they will connect to each other automatically. When the two trackers' lights flash quickly and continuously, they are connecting to each other.

**Note:** The connecting range varies with different environments. The more obstacles (physical and metal barriers) between the two trackers, the shorter the distance is. The connecting range will be better in open areas.

## FAQ

1 How long will tracker work with one battery? What should I do if the battery is run down?

Generally one battery can work for about 2-4 months. If the battery runs down, please replace a new battery. The battery is CR2032 button cell which you can find at most battery retailers easily. Just open the shell and replace the battery, please make sure the battery's positive pole is placed upwards and the red arrows on both shells coincide. Then assemble the tracker and press the button for 5 seconds and it will begin to work.

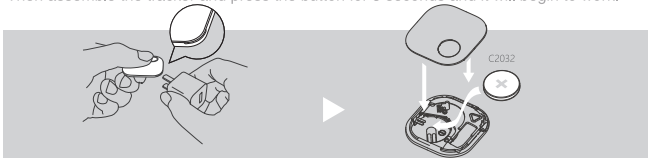

2 Does Twins need to connect to a Mobile phone or APP?

Twins connects to each other through Bluetooth directly, they need not connect to a phone or the APP.

3 Will the Twins sound an alarm by mistake?

If there are water and metal barriers between devices, Bluetooth signal will be shielded and disconnected, and the device will sound an alarm. In your daily use, please try to avoid physical and metal barriers between the two devices to reduce the possibility of Bluetooth disconnection.

4 How loud is the alarm volume of the Twins?

The volume of tracker is about 80-90 decibels. It may not be heard in very noisy environments. It is suggested that in daily use, put tracker where the sound is not blocked, such as hanging on mobile phones, keys, bags, or in jacket pockets, etc.

5 Can tracker still sound an alarm after the other one shuts down?

If two trackers are connected to each other, it will sound an alarm when the other one shuts down because Bluetooth is disconnected. After the other one shuts down, tracker will not alarm again.

6 Is iMagic tracker waterproof?

If tracker falls into the water, it will automatically shut down. Please turn it on after the circuit board is dry.

7 How far is the effective connection distance between the two devices?

The effective connection distance between the two devices is about 10-20 meters. The Bluetooth distance varies with different environments. The more obstacles (physical and metal barriers) between the two devices, the shorter the distance is. The distance will be greater in open areas.

FCC Caution: Any changes or modifications not expressly approved by the party responsible for compliance could void the user's authority to operate this equipment.

This device complies with Part 15 of the FCC Rules. Operation is subject to the following two conditions:

- (1) This device may not cause harmful interference, and
- (2) this device must accept any interference received, including interference that may cause undesired operation.

The device has been evaluated to meet general RF exposure requirements. The device can be used in portable exposure conditions without restriction.

**NOTE:**

This equipment has been tested and found to comply with the limits for a Class B digital device, pursuant to Part 15 of the FCC Rules.

These limits are designed to provide reasonable protection against harmful interference in a residential installation. This equipment generates, uses and can radiate radio frequency energy and, if not installed and used in accordance with the instructions, may cause harmful interference to radio communications.

However, there is no guarantee that interference will not occur in a particular installation.

If this equipment does cause harmful interference to radio or television reception, which can be determined by turning the equipment off and on, the user is encouraged to try to correct the interference by one or more of the following measures:

- Reorient or relocate the receiving antenna.
- Increase the separation between the equipment and receiver.
- Connect the equipment into an outlet on a circuit different from that to which the receiver is connected.
- Consult the dealer or an experienced radio/TV technician for help.

For technical documents and more

Please visit **imagicliving.com**

Tel: **1- 866-201-3421**

Email: **support@imagicliving.com**